

## Stainless Steel Hydraulic Separators



LLH100 - With Insulation

LLH125

LLH150

LLH200

### Functions:

- Separate the primary (boiler) loop from the secondary loops
- Slow down the flow allowing air to escape on top
- Expansion tank/water makeup connection point at no pressure change
- Mix supply and return waters for a gradual  $\Delta T$
- Allow dirt to settle and be drained

## Stainless Steel Hydraulic Separators

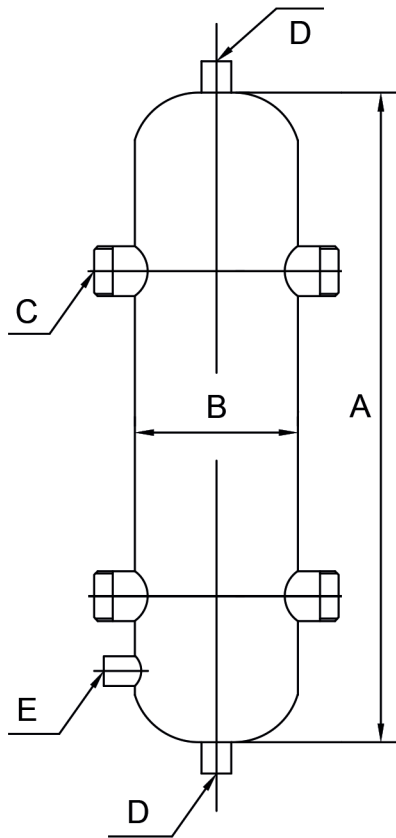

### 304 Stainless Steel hydraulic separator with 1", 1-1/4", 1-1/2" or 2" MIP Connectors.

- LL100 with 1" MNPT Flow Rate: **11 GPM** (2.5 m<sup>3</sup>/h)\*
- LLH125 with 1-1/4" MNPT Flow Rate: **18 GPM** (4 m<sup>3</sup>/h)\*
- LLH150 with 1-1/2" MNPT Flow Rate: **26 GPM** (6 m<sup>3</sup>/h)\*
- LLH200 with 2" MNPT Flow Rate: **37 GPM** (8.4 m<sup>3</sup>/h)\*

\* at 4 foot/sec

- Internal baffle
- 1/2" GF top air vent connection
- 1/2" GF bottom drain connection
- 1/2" FIP side water makeup connection

#### Included are:

- 1 x Hydraulic separator
- 1 x 1/2" Air vent
- 1 x 1/2" Bottom drain

Model Number	A	B	C	D	E	F	Weight
LLH100	15-3/4"	3"	1" MIP	1/2" GF	1/2" GF	1/2" FIP	3.5 lbs
LLH125	20-1/2"	4"	1-1/4" MIP	1/2" GF	1/2" GF	1/2" FIP	5.8lbs
LLH150	22"	5-1/4"	1-1/2" MIP	1/2" GF	1/2" GF	1/2" FIP	8.3lbs
LLH200	25-1/4"	6-1/4"	2" MIP	1/2" GF	1/2" GF	1/2" FIP	12.2lbs